



Key

-  Existing 40mph speed restriction
-  Existing 30mph speed restriction
-  Proposed new 30mph speed restriction

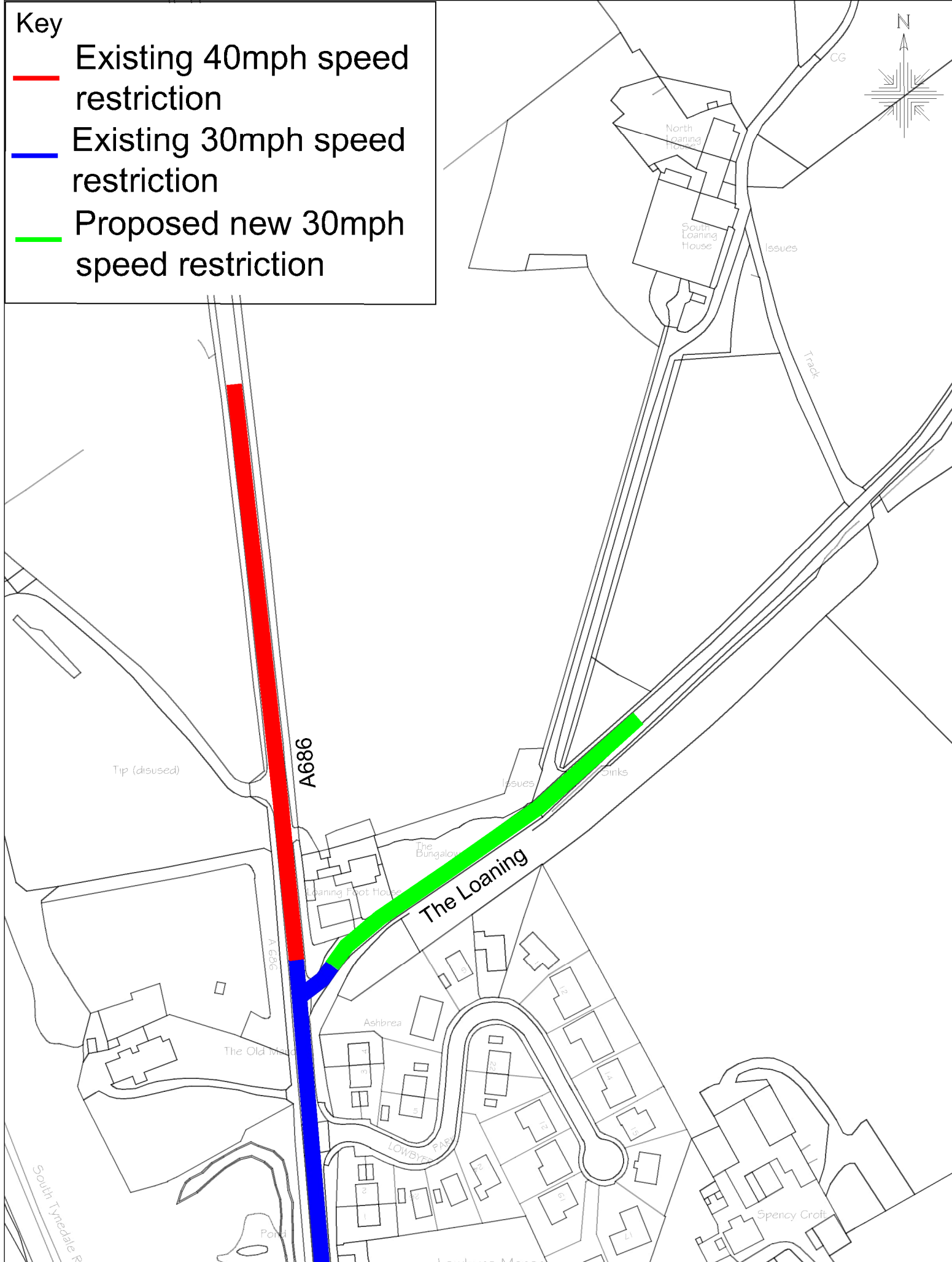
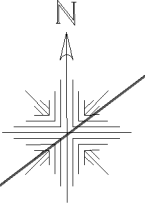

Skirsgill Highways Depot
Skirsgill,
Penrith. CA10 2BQ

Proposed New 30mph Speed Restriction
The Loaning, Alston
Grid Ref 371685,547076

Crown Copyright Licence LA 100019596

Drawing No:	Alston-40mph-12.23	
Scale:	NTS	Date: Dec 23
Drawn:	JBM	Checked: DE